

Spare parts list
BioBasic RF410



Description :

Spare parts list for
BioBasic RF 410

Compiled.		Latest revision.			Deleted.	
Date	Name	Date	Name	Rev.no	Date	Name
03.09.15	JP	30.09.22	JP	008		

Exploded view

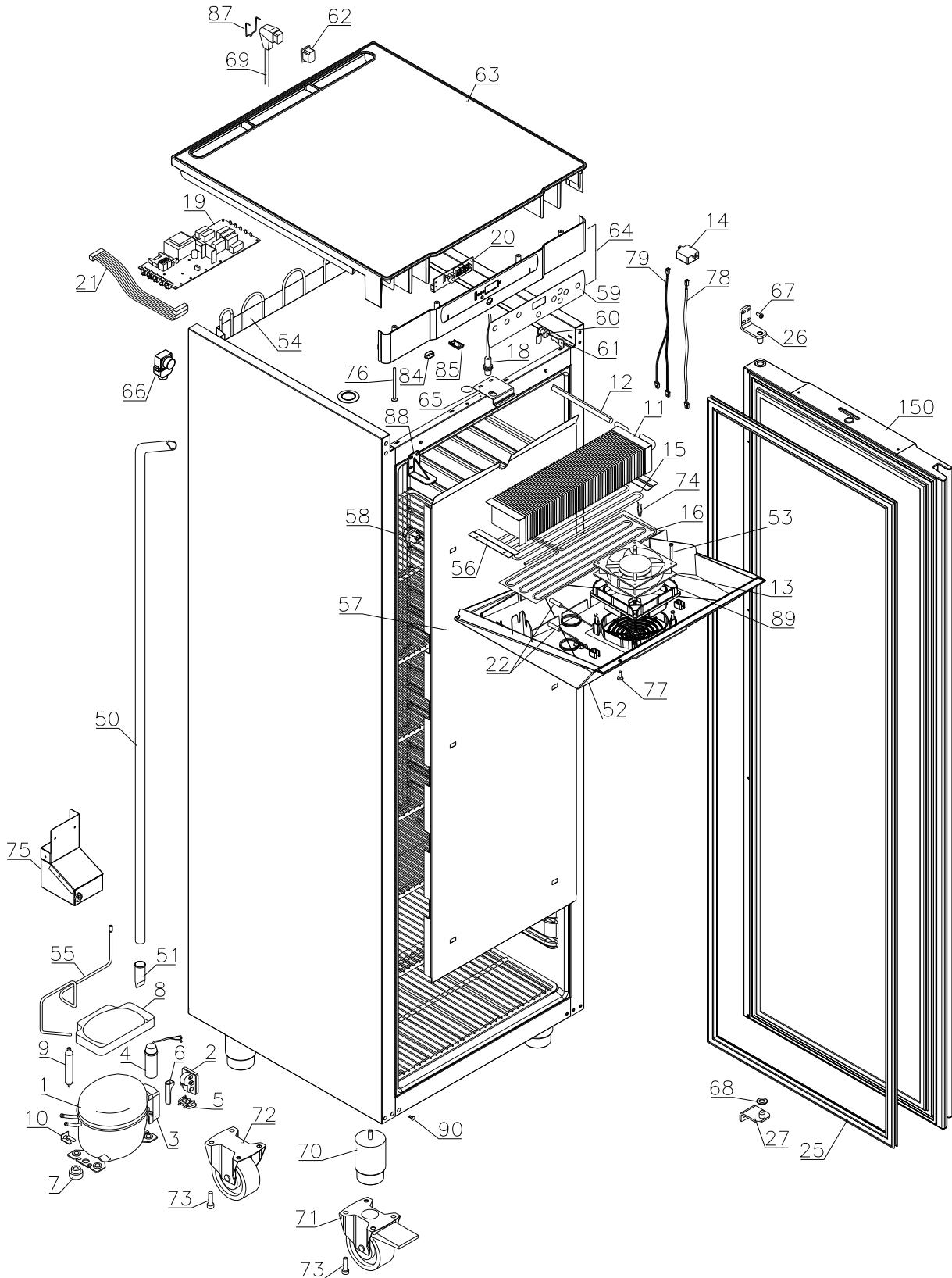

Description :

**Spare parts list for
BioBasic RF 410**

Compiled.		Latest revision.			Deleted.	
Date	Name	Date	Name	Rev.no	Date	Name
03.09.15	JP	30.09.22	JP	008		

Item no.	Description	Gram part no.	Week/year:	
			Issued	Deleted

Essential spare parts

RF 410 G

1	Compressor NLX13KK.1	500550096	3715
2	Starting device	453050178	3715
3	Cover	452440293	3715
4	Run capacitor 4 µF	451723513	3715
5	Cord relief	452440297	3715
6	Protection screen PTC	452440290	3715

RF 410 H

1	Compressor NLY9FK	500550095	3715
2	Starting device	453050178	3715
3	Cover	452440293	3715
4	Run capacitor 4µF	451723513	3715
5	Cord relief	452440297	3715
6	Protection screen PTC	452440290	3715

Common parts:

7	Rubber bush	760080519	3715
8	Re-evaporation tray	410820011	3715
9	Filter drier	761221322	3715
10	Compressor clip	760082367	3715
11	Evaporator	765080207	3715
12	Heat exchanger	761221416	3715
13	Evaporator fan 12V DC	765071196	3715
14	Trafo for fan (kit)	761234127	3715
14	Trafo for fan	765072987	1521
15	Defrost heater	765071197	3715
16	Drip tray heater	765071199	3715
18	Door switch	450400111	3715
19	Electr.contr., power part F70	761256165	3715
20	Electronic controller, display part	612900056	3715
21	Band cable	765072661	3715
22	Temperature sensor	453531501	3715
25	Door gasket	761222729	3715
26	Top hinge	761222906	3715
27	Bottom hinge	761222904	3715

Description :

**Spare parts list for
BioBasic RF 410**

Compiled.		Latest revision.			Deleted.	
Date	Name	Date	Name	Rev.no	Date	Name
03.09.15	JP	30.09.22	JP	008		

Item no.	Description	Gram part no.	Week/year Issued	Deleted
----------	-------------	---------------	---------------------	---------

Other spare parts

50	Drain pipe	761221756	3715	
51	Water trap	760082891	3715	
52	Drip tray, white	761223101	3715	
53	Screw for fan	420790001	3715	
54	Condenser	761223011	3715	
55	Re-evaporation pipework	760000323	3715	
56	Evaporator suspension bracket	761223070	3715	
57	Air distribution plate	761222998	3715	
58	Suspension plug	765081213	3715	
59	Label for controller	765041713	3715	
60	Door lock	765080093	3715	
61	Key	761220166	3715	
62	Appliance inlet	451022002	3715	
63	Tabletop upper part, white	761222630	3715	
64	Tabletop front, white	761222781	3715	
65	Lock bracket	761222761	3715	
66	Air relief valve	765081206	3715	
67	Screw for hinge	420090100	3715	
68	Washer	760250524	3715	
69	Mains cable, EU	765072566	3715	
69	Mains cable, UK	765072567	3715	
69	Mains cable, DK	765072568	3715	
70	Leg H=100-130 mm	765080118	3715	
71	Castor w/brake H=125 mm	480260050	3715	
72	Castor	480270520	3715	
73	Screw M8x16	422715065	3715	
74	Bracket for evaporator heater	761222779	3715	
75	Condenser fan complete	761221780	3715	
76	Screw M4x70	420178125	3715	
77	Screw M4x16	422701019	3715	
78	Fan wire	765072656	3715	
79	Heater wire	765072668	3715	

Gram Commercial
Technical information

765041764

Description :

**Spare parts list for
BioBasic RF 410**

Compiled.		Latest revision.			Deleted.	
Date	Name	Date	Name	Rev.no	Date	Name
03.09.15	JP	30.09.22	JP	008		

Item no.	Description	Gram part no.	Week/year	
			Issued	Deleted
87	Brace for mains cable	761230215	3715	
88	Cover bracket, white	761222758	3715	
89	Rubber gasket	761223110	3715	
90	Cover plug, white	765080504	3715	
150	Door complete, white	761232772	3715	
200	Wire shelf large, white	818721001	3715	
201	Wire shelf small, white	818721019	3715	